



Water Leak Detection Packages

Everything required to install and operate a water leak detection alarm for a Teapoint area.

Also ideal for Coffee stations and small kitchens.

Easy connection terminals for fast installation.

Optional actuated ball valves, unaffected by water pressure or hardness.

Standard BMS connection via a volt free relay.

Optional external beacon and/or sounder to increase awareness when installed in a more remote location.

Handy test button to ensure alarm functionality at any time.

By installing a Teapoint leak detection alarm, you can save time, money and water in the event of a leak.

Tea Point Leak Detection Packages

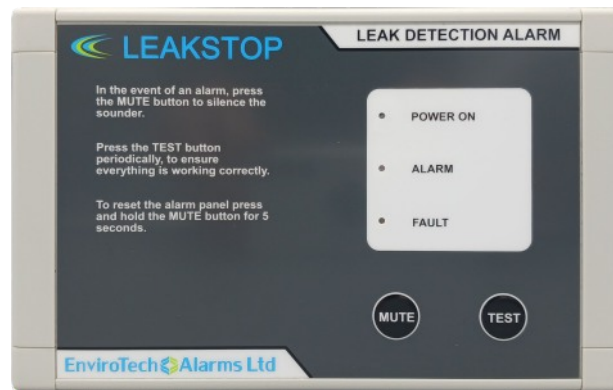

Water leak detection made simple with a Tea Point package from Envirotech Alarms. Everything you need to protect against water leaks, minimising down time for your business, less clear up to do and saves water. These reliable, easy to install alarms offer peace of mind and can save you money in the event of a water leak.

The Tea Point package uses a sensor tape that when touched by water will trigger an alarm. Each package includes a LeakStop alarm panel, which has an audible alarm and a red flashing light when an alarm occurs. The package also has an optional (3/4") valve that automatically closes and shuts off the water on detection of a leak. This prevents further loss of water as well as minimises the possible damage the escaping water might do. Connection cables for the valve and to connect the sensor tape come as part of the package, so there's no need to find any additional materials when it comes to installation. The LeakStop alarm panel has a handy test button, useful for periodic maintenance testing and a mute button which will silence the sounder whilst at the same time leaving the red alarm light flashing. BMS connection is standard via a volt free relay contact.

PACKAGE INCLUDES:

Leak-Stop Alarm Panel
3m of connection cable
3m of sensor tape
5 x floor clips
Optional Actuated Ball Valve
5m valve connection cable
2m mains fly lead
BMS Connection



EnviroTech Alarms Ltd

Sensors

TECHNICAL SPECIFICATION

Sensor Tape

The sensor tape used with the LeakStop water leak detection alarms has been specifically designed to detect the presence of water at any point along its' length. Sensor tape can be laid directly on the floor or strapped under pipework (braided sensor tape is required). A specific length of sensor tape can be used to cover the area requiring water leak detection. It is possible to connect more than one length of sensor tape in parallel, using start and end of line junction boxes. When installing the sensor tape on a floor, self adhesive floor clips can be used to hold it in place.



Category Type:	4C Sensor Cable Orange
Conductor Material:	Stainless steel wire
Conductor Diameter:	0.40mm
Insulation Material:	PVC
Insulation Diameter:	1.8mm(+/-0.10mm) x 4 twisted
Compliant:	RoHS2 (2011/65/EU)
Temperature rating:	-20°C to +80°C
Voltage rating:	5Volts @ 10 Milliamps

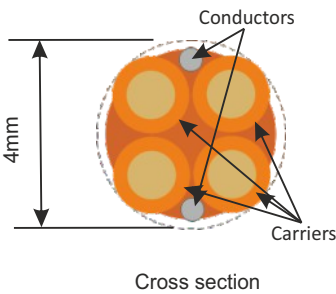

(Connectors are pre-wired in the factory)

Installation Notes::

Sensor tape can be laid directly on the floor or strapped under pipework (braided sensor tape is required). A specific length of sensor tape can be used to cover the area requiring water leak detection. Lengths up to 100m are available (this is combined with the length of the connection cable).

Installing the sensor tape

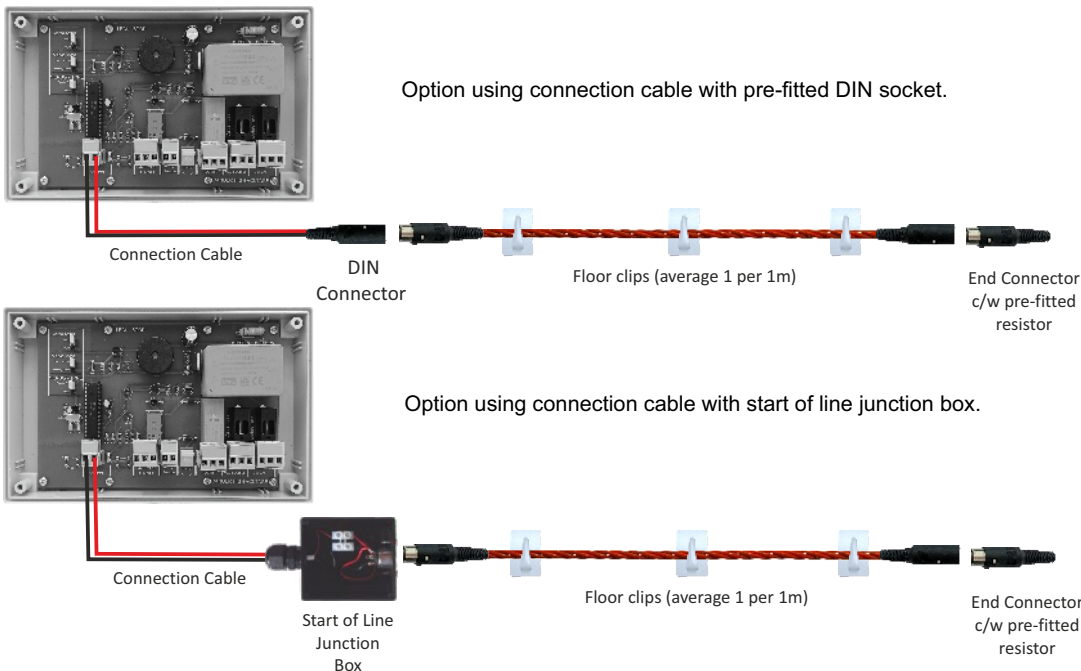

PLEASE NOTE THAT WHEN THE LEAKSTOP ALARM PANEL IS PART OF A PACKAGE THE CONNECTION CABLE IS TERMINATED AT A PRE-DEFINED LENGTH WITH A NON LOCKING CONNECTOR

Applications:

Under raised floors

In data centres

Comms rooms

Plant rooms

Tea points

Kitchen areas

Coffee Stations

Under pipes (a braided version is available for this)

Behind splash panels in toilet areas

Pub Cellars

Basements



Start of Line Junction Box



Self Adhesive Floor Clip

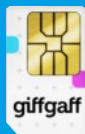

SMS TEXT DIALLER

SUMMARY OF FEATURES

- Easy to install.
- Simple programming via text messaging.
- 4 inputs available.
- Up to 5 telephone number can be programmed.
- Separate text messages can be set up for each channel.
- Volt free relays for connecting external devices.
- Excellent mobile phone network coverage.



The SMS Autodialer acts like a mobile phone sending a bespoke text message to 5 different telephones. It has four inputs available that allow different devices to be linked to the dialler and a different message set for each.

The SMS Autodialer uses a SIM card inserted into the PCB and most larger network providers will work perfectly well (please check the signal strength and network availability for the area where the text dialler will be installed). Setting up the system is done by texting simple commands to the unit. Contract and PAYG SIMs can both be used, when using a PAYG the unit can be set up to send an automatic text periodically to prevent the SIM from expiring.

BEACONS, SOUNDERS AND BEACON/SOUNDERS

Both the Beacon Alarm and the Beacon/Sounder Alarm can be connected to any Envirotech alarm panel. Should the main alarm panel detect a leak, the beacon will flash and the sounder sound.

These panels simply plug straight into the LeakStop alarm panel using a 2 core alarm cable. Should a leak be detected an alarm will trigger and a signal is sent straight to the Beacon alarm illuminating the ultra bright beacon and sounding the 102 dB sounder.

SUMMARY OF FEATURES

Very bright LED beacon (visible for 30m plus), 102 dB sounder, No local power required as power is taken directly from the master panel. Automatically resets as soon as the master panel resets.

PRODUCT SPECIFICATION

Beacon	Super Bright LED
Sounder	102dB @ 1m
Input Voltage	12VDC (selv) 50mA
Operating Temperature	-18°C to 50°C
Connection Cable	2 or 4 core 0.2mm ²
IP Rating conductor	65
Dimensions	155mm x 115mm x 75mm
Dimensions including beacon	155mm x 160mm x 75mm

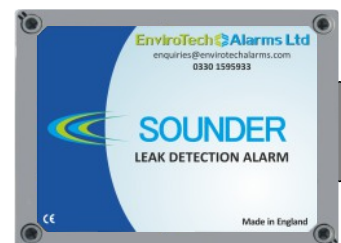

Key Features:

102 dB sounder

Super bright beacon

Ideal for otherwise noisy areas

Powered directly from the main alarm panel

Auto resets once leak has been fixed

Ideal for positioning outside of a comms room where access to the room is limited

Actuated Ball Valve

1/2" - 1"

NORMALLY OPEN
ZERO RATED
0 - 10 Bar



Media: air - water -gas - light oil
Pressure range: 0 to 10 Bar max
Media temp: -15°C to +100°C
Ambient temp: -15°C to +50°C
Media viscosity: 500 centistokes max
Mounting: Any Position
Open/Close time: 5 Secs max
Voltage: 230VAC
Power Consumption: 5 Watts (moving)
Enclosure: IP67
Connections: 3 wire control (0.5m lead)
Duty Cycles: 100,000
Seals: PTFE
Moulded coil: ABS plastic

Key Features:

230VAC

Available in 1/2" - 3/4" - 1" - 1 1/4" - 1 1/2" - 2"

Full bore diameter

Standard BSP fittings

Not affected by low water pressure

Capable of working with water pressures up to 10 Bar

Operates with water temperatures of between -15C to +100C

Can be mounted in any position

Normally closed version available

1 1/4" - 2"

NORMALLY OPEN
ZERO RATED
0 - 10 Bar



Media: air - water -gas - light oil
Pressure range: 0 to 10 Bar max
Media temp: -0°C to +90°C
Ambient temp: -15°C to +50°C
Media viscosity: 500 centistokes max
Mounting: Any Position
Open/Close time: 10 Secs max
Voltage: 230VAC
Power Consumption: 5 Watts (moving)
Enclosure: IP67
Connections: 3 wire control (0.5m lead)
Duty Cycles: 100,000
Seals: PTFE
Moulded coil: ABS plastic

Port BSP	Orifice (mm)	Torque Nm	Pressure Rating (Bar)		Sec Max		Voltage
			Min	Max	Open	Close	
1/2"	15	2	0	10	5	5	AC
3/4"	20	2	0	10	5	5	AC
1"	25	2	0	10	5	5	AC
1 1/4"	32	16.3	0	10	10	10	AC
1 1/2"	40	16.3	0	10	10	10	AC
2"	50	16.3	0	10	10	10	AC

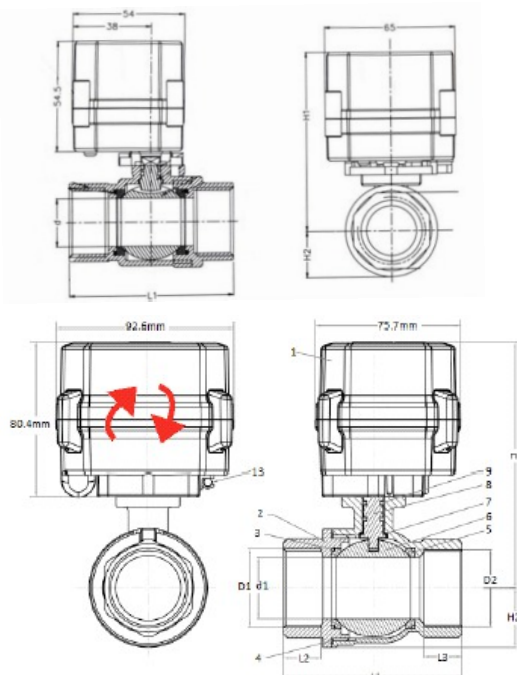

Port D1/D2	d	L1	L2	E1	H1	H2	Kg
1/2	15	63	14	25	83	17	0.4
3/4	20	72	17	31	87	20	0.5
1	25	81	18	38	95	24	0.6

Port	Bore D1	L1	L2 / L3	E1	H1	H2	KG
1 1/4	32	102	23	47	122	31	1.4
1 1/2	38	115	25	52	130	36	1.7
2	50	130	25	66	141.4	44.5	2.3